





### SCHEDULE OF SHOPS PLOT:-

S.NO.	SIZE	NOS.
1.	3.00 X 4.50 M.	07 (REVISED)
2.	3.00 X 6.00 M.	04
3.	4.50 X 6.00 M.	02
<b>TOTAL</b>		<b>= 13</b>

NOTE:-  
EARLIER APPROVED IN 93 P.C. MEETING ON DATED 8.9.02

REVISED PORTION SHOWN THUS:



ALL DIMENSION ARE IN METER

REVISED PLAN OF CONVENIENT SHOPS  
AT BLOCK NO. 48 IN SECTOR -04,  
MANSAROVER, JAIPUR

DRG. NO. - R/18/HO/2021/	SCALE -
DATED - 10-12-2021	FILE NO. -
DEALT. - HARI MOHAN VERMA	CHD. BY. - ANIL VERMA

*Mohd. Kashif*  
(MOHD. KASHIF)  
ASSTT. TOWN PLANNER

*Anil Mathur*  
(ANIL MATHUR)  
SENIOR TOWN PLANNER

*Anil Mathur*  
(ANIL MATHUR)  
ADDL. CHIEF TOWN PLANNER

RAJASTHAN HOUSING BOARD

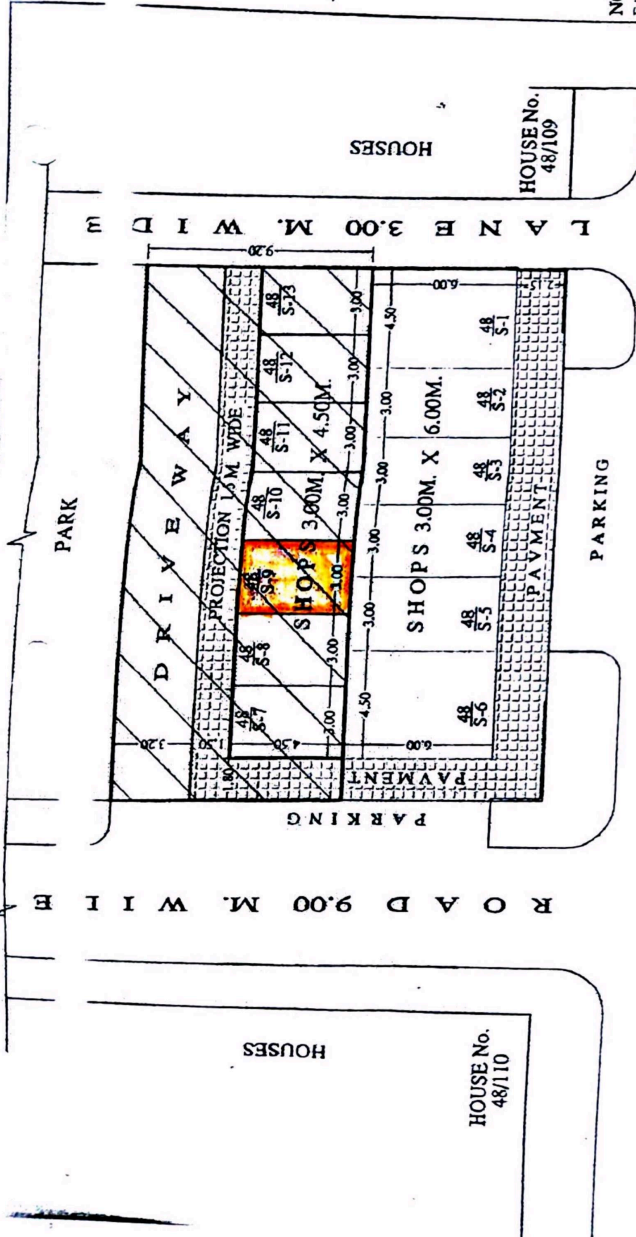

R O A D 24.00 M. W I D E

(RAJATPATH)

S E C T O R - 6

SECTOR NO. 05 ZONE -55



**SCHEDULE OF SHOPS PLOT:-**

S.NO.	SIZE	NOS.
1.	3.00X4.50 M.	49
2.	KIOSKS 2.0 X2.00 M.	22



LAY OUT PLAN OF CONVENIENT SHOPS  
IN SECTOR -05 , ZONE - 55  
MANSAROVAR, JAIPUR

DRG. NO. H11102/21	SCALE. 1:200
DATED.:	FILE NO.:
DEALT:	CRD. BY.:
(Y. SINGH) ASSTT. TOWN PLANNER	(K.N. VERMA) TOWN PLANNER
(C.K. RASTOGI) SR. TOWN PLANNER	(P. SINGH) HOUSING COMMISSIONER

**RAJASTHAN HOUSING BOARD**

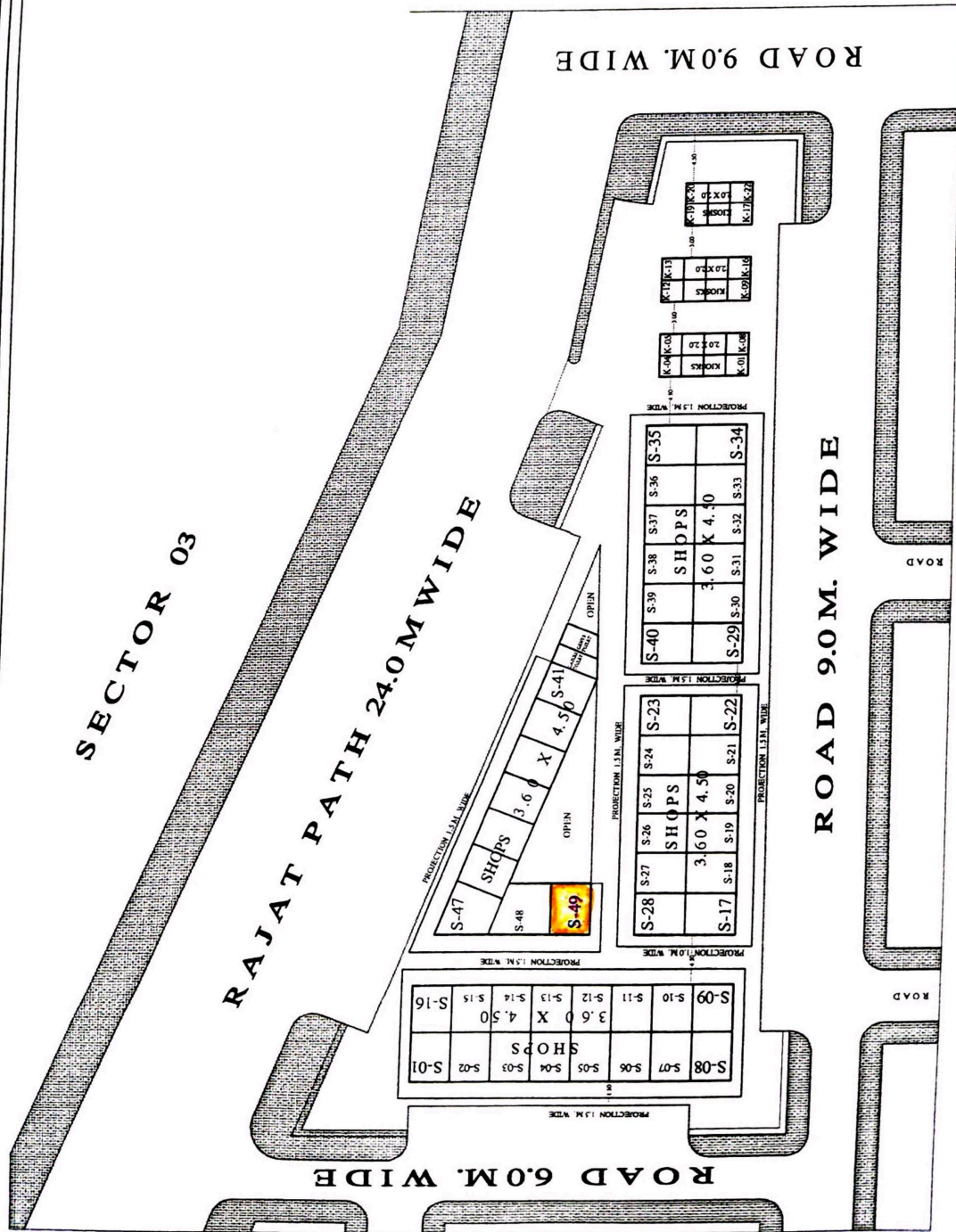



PRIMARY SCHOOL

ROAD 12.00 M. W I D E

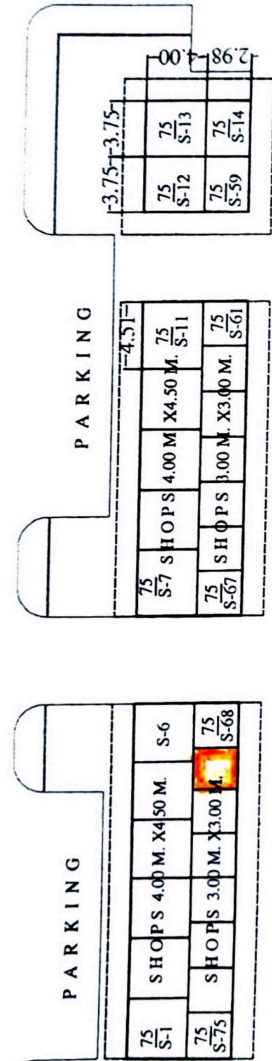

P H E D

28.50

ROAD

L I G - 23 H O U S E ( 6.0 X 12.0 M )

75  
166

75  
143

75  
155

75  
153

ROAD 9.00 M. W I D E

M I G II 8.0. X 15.00 M.

ZONE NO. 75 SECTOR NO. 7 MANSAROVER

75  
60

M I G II 8.0. X 15.00 M.

77/225

ROAD 9.00 M W

77/226

M I G II 8.0. X 15.00 M.

R O A D 12.00 M. W I D E

ZONE NO. 101 SECTOR NO. 10



ANALYSIS OF SHOPS PLOT:-

S.NO.	PLOT SIZE	NOS.OF
1.	3.00X3.50 M.	05
2.	3.0 X4.50 M.	05
3.	3.0X4.80 M.	06
4.	3.0X6.00 M.	10
5.	4.5X4.5 M.	04
6.	4.0X4.5 M.	08
7.	4.0X4.8 M.	01
8.	4.5X4.8 M.	01

TOTAL = 40



NOTE:-  
 1. NOT TO BE USED AS PER DRAWING 7 VIDE  
 OFFICE N. SHEET DATA IN 101/10  
 2. HOTEL- APPROVED IN P.F.C. (RAJASTHAN DATED 9-8-82)

PROPOSED LAYOUT PLAN OF  
 CONVENIENT SHOPS AT BLOCK NO. 101  
 IN SEC. NO. 10 MANSAROVER JAIPUR

DIR. NO. RH/HR/2002/2	SCALE: 1:200
DATED: 05-02-82	FILE NO. :-
DEALT:-	CKD BY:-
(Y.SINGH) ASSTT. TOWN PLANNER	(M.K. KHANNA) HOUSING COMMISSIONER

RAJASTHAN HOUSING BOARD

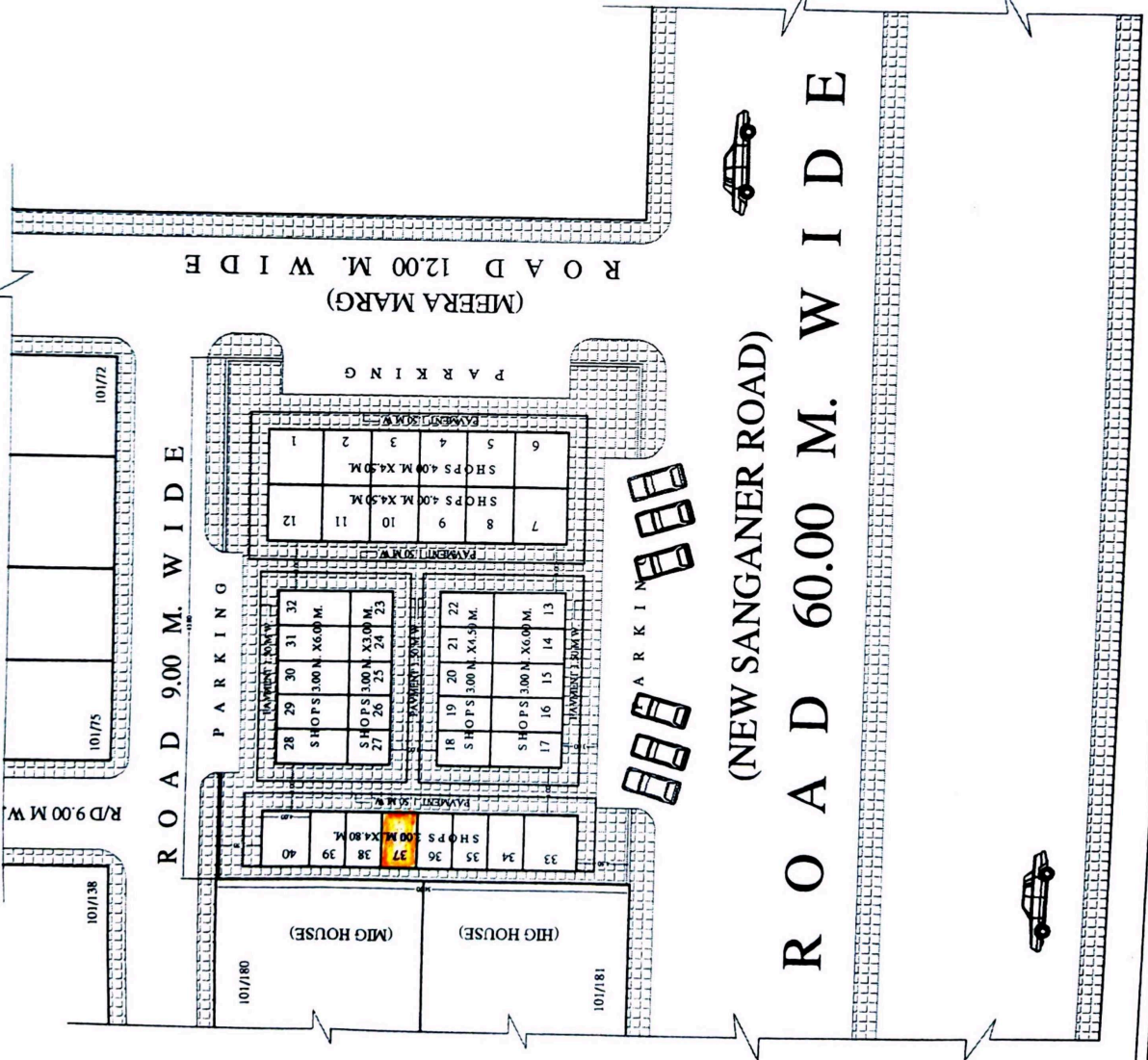

SECTOR NO. 10 ZONE -106



**ANALYSIS OF SHOPS PLOT:---**  
**BLOCK NO. 106:---**

S.NO.	SIZE	NOS.
1.	3.00X3.50 M.	06
2.	3.0 X4.50 M.	20
3.	3.0 X6.00 M.	06
<b>TOTAL =</b>		<b>32</b>



**REVISED LAYOUT PLAN OF CONVINIENT SHOPS AT BLOCK NO. 106 IN SECTOR - 10 MANSAROVER, JAIPUR**

DRG. NO - RH/HQ/2002/P	SCALE - 1:200
DATED -	FILE NO. :-
DEALT -	CKD BY :-
(V.SINGH) ASSTT. TOWN PLANNER	
(M.K. KHANNA) SR. TOWN PLANNER	HOUSING COMMISSIONER

**RAJASTHAN HOUSING BOARD**

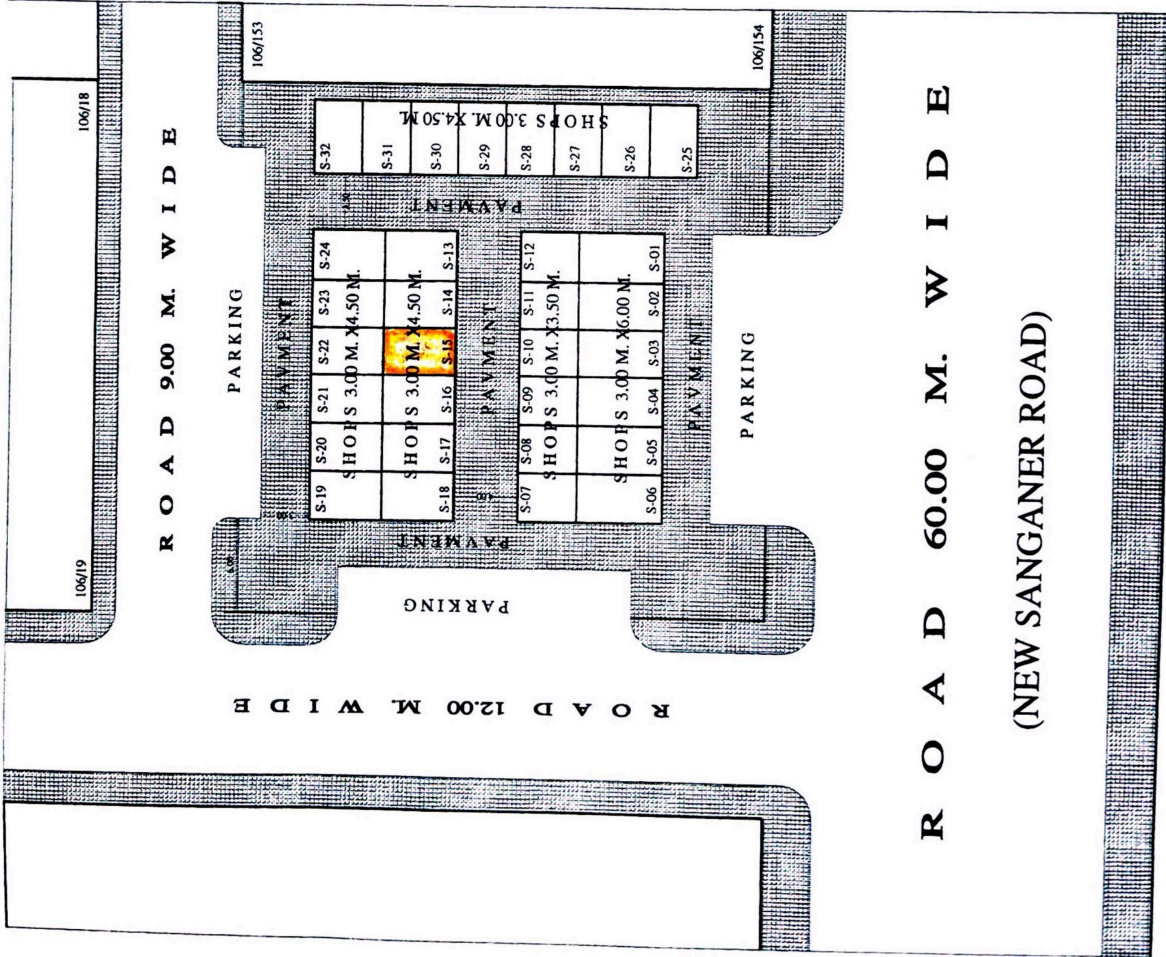

**R O A D 60.00 M. W I D E**

**(NEW SANGANER ROAD)**

ZONE NO. 119-B SECTEOR NO. 11



**REEERENCES:-**

S.NO.	TYPE	SIZE	NOS.
1.	A	3.00X4.50M.	8
2.	B	3.00X3.00M.	16
3.	C	3.00X3.00M.	8
TOTAL			= 32



NOTE-

REVISED PLAN OF CONVINIENT SHOPS  
SECTOR :- 11 MANSAROVAR, JAIPUR

DRG. NO. - RHB/HQ	SCALE -
DATED -	FILE NO. -
DEALT -	CKD BY -
(Y.SINGH) ASSTT. TOWN PLANNER	VIRESH JHALANI DY TOWN PLANNER
S.L.A.RIZVI SR. TOWN PLANNER	PREETAN SINGH HOUSING COMMISSIONER

**RAJASTHAN HOUSING BOARD**

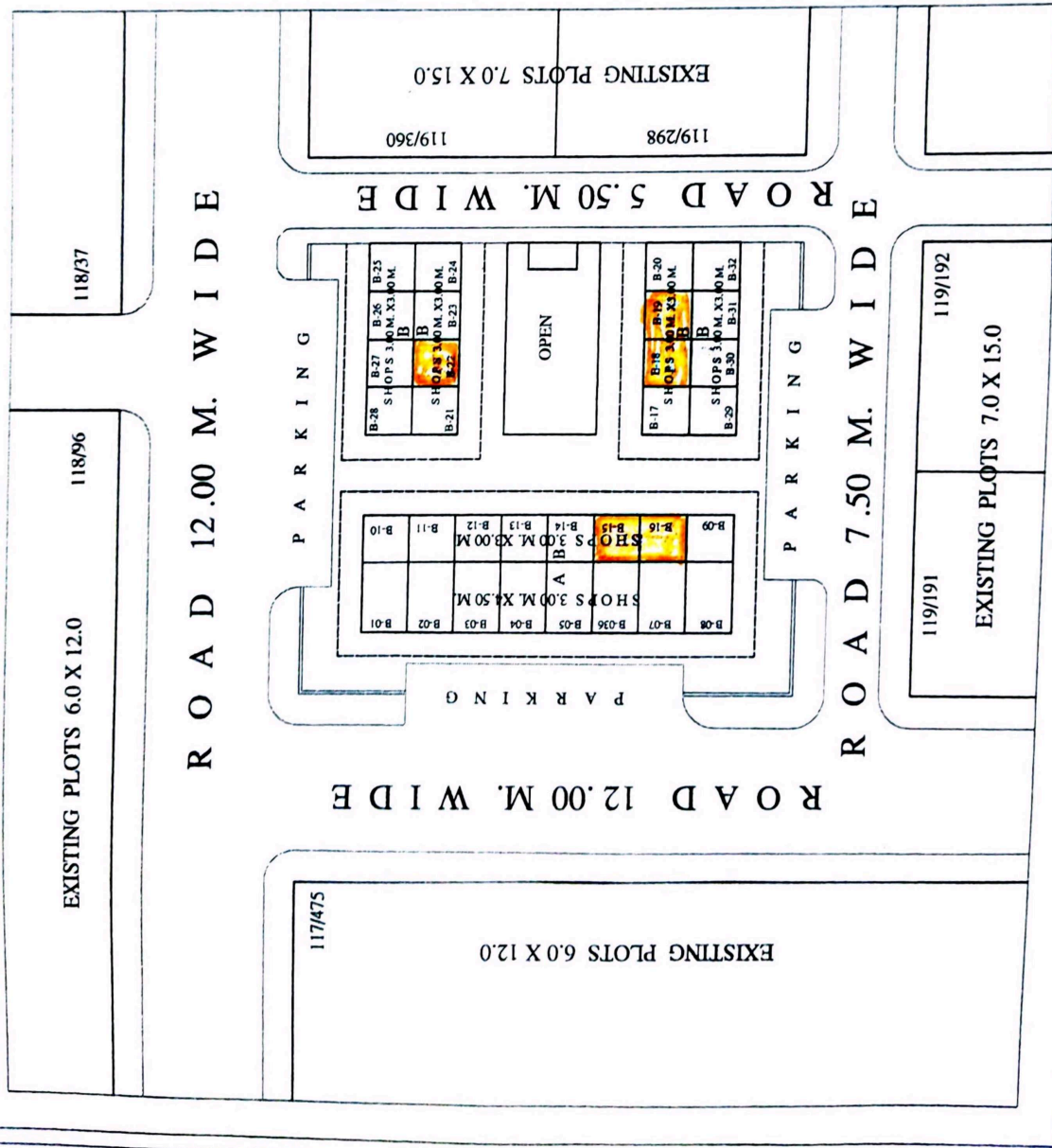

EXISTING PLOTS 6.0 X 12.0

118/96

118/37

ROAD 12.00 M. WIDE

PARKING

ROAD 12.00 M. WIDE

PARKING

ROAD 5.50 M. WIDE

EXISTING PLOTS 7.0 X 15.0

119/360

119/298

117/475

EXISTING PLOTS 6.0 X 12.0

PARKING

ROAD 7.50 M. WIDE

119/191

119/192

EXISTING PLOTS 7.0 X 15.0

ZONE NO. 122A SECTEUR NO. 12

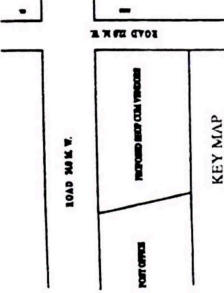

**SCHEDULE OF SHOPS:-**

S.NO.	SIZE	NOS.
1.	4.50X6.00M.	12
2.	3.00X4.50M.	16
TOTAL		28

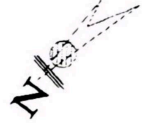

TOTAL NOS OF VENDORS 128

NOTE:-  
PLAN ONE COLUMN IN SHOP NO. 128

**PROPOSED LAYOUT OF SHOPS  
SHOPS CUM VENDORE IN  
SECTOR :- 12 MANSAROVAR, JAIPUR**

DRG. NO. - RH/10/2002/5  
 FILE NO. ...  
 DATED ...  
 SCALE: ...  
 DESIGNED BY ...  
 CHECKED BY ...

(Y. SINGH)  
 ASSTT. TOWN PLANNER  
 VIRESH JHALANI  
 SR. TOWN PLANNER  
 M.K. KIANNA  
 HOUSING COMMISSIONER

**RAJASTHAN HOUSING BOARD**

**ROAD 24.00 M. W I D E  
(MADHYAM MARG)**

**ROAD 12.00 M. W I D E**

**P A R K I N G**

**P A R K I N G**

**WOOD LAND**



POST OFFICE



ZONE NO. 122-B SECTOR NO. 12



**SCHEDULE OF SHOP & KIOSKS**

S.NO.	TYPE	SIZE	NOS.
1.	SHOPS	3.00 M. X 3.00 M.	18
2.	SHOPS	4.50 M. X 4.50 M.	06
3.	SHOPS	4.50 M. X 6.00 M.	06
4.	KIOSKS	2.00 M. X 2.00 M.	33
TOTAL NOS.			63

SHOPS NO. 122 / S-1 TO 122 / S-30  
 KIOSKS NO. 122 / K-1 TO 122 / K-33



NOTE:  
 1. LAND USE CHANGE IN P.C. 92 rd DT. 29-01-2002  
 2. MEASUREMENT SEND BY DHC II 1031 DATED 22.10.03

**PROPOSED SHOPS, FRUIT & VEGETABLE MARKET AT BLOCK 112, SEC-12 MANSAROVAR, JAIPUR**

DRG. NO. - RH/10/2003	SCALE: 1:200
DATED: 14.11.2003	FILE NO.:
DEALT:	CKD BY: :
(D.SINOH) ASSTT. TOWN PLANNER	(KULDEEP SHARMA) HOUSING COMMISSIONER
<b>RAJASTHAN HOUSING BOARD</b>	

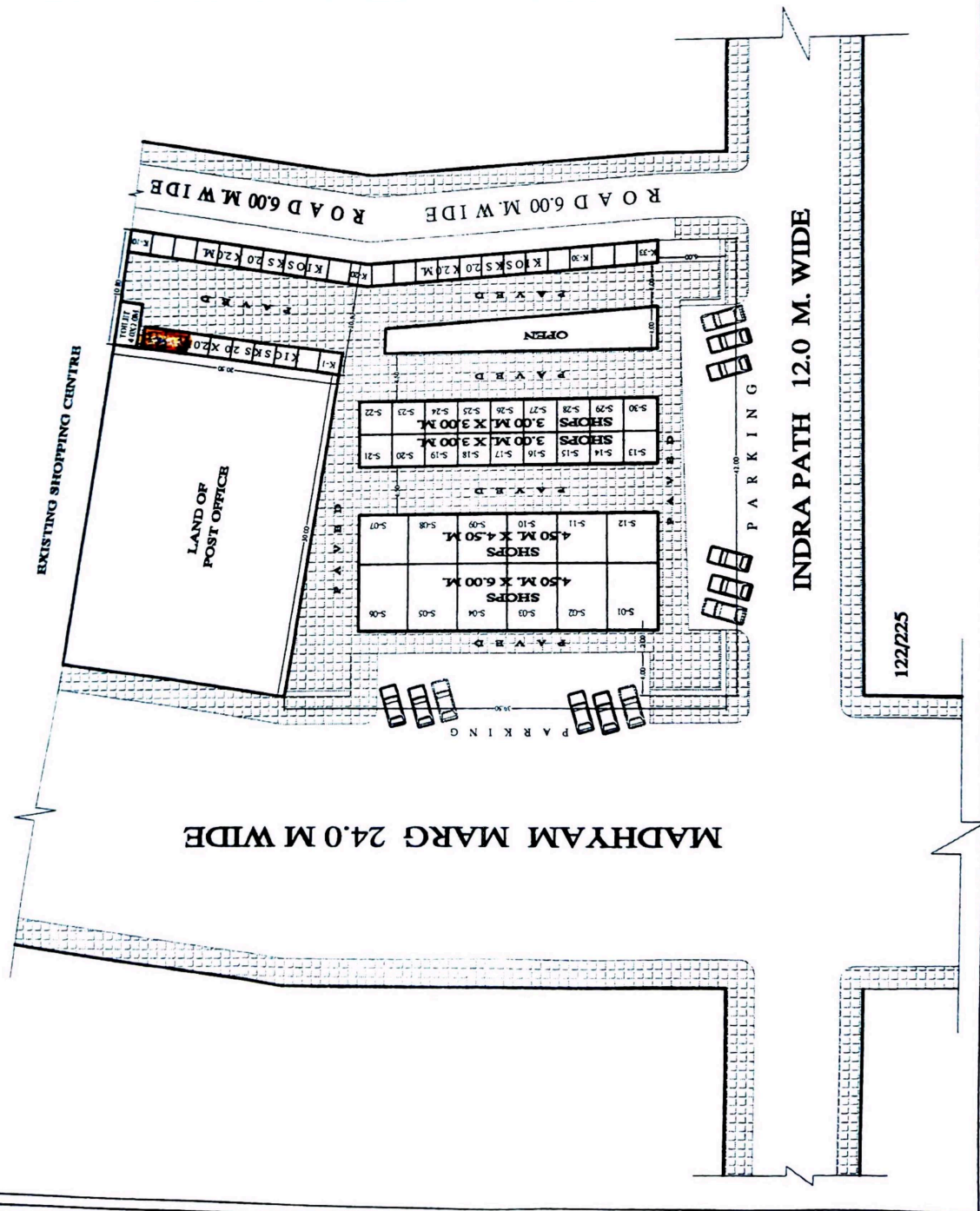

122/225